



**PROGETTO
DEFINITIVO/ESECUTIVO**

PIANO STRAORDINARIO EDILIZIA SCOLASTICA
ISCOL@ - ANNUALITA' 2015
Lavori di adeguamento funzionale e alle norme di
sicurezza della Scuola Materna di Via Bellini

PROGETTAZIONE AREA E COOP - COMUNE DI SELARGIUS:
Geom. Fabrizio PERRA



| TAVOLA | 3 | SCALA | 1:100 | DATA | 11/11/2015 |
|--------|---|-------|-------|------|------------|
| | | | | | |

PIANTA DEGLI INTERVENTI

TAVOLE DI APPROVAZIONE

IL RESPONSABILE DEL PROCESSIONE
Ing. Enrico SIDA

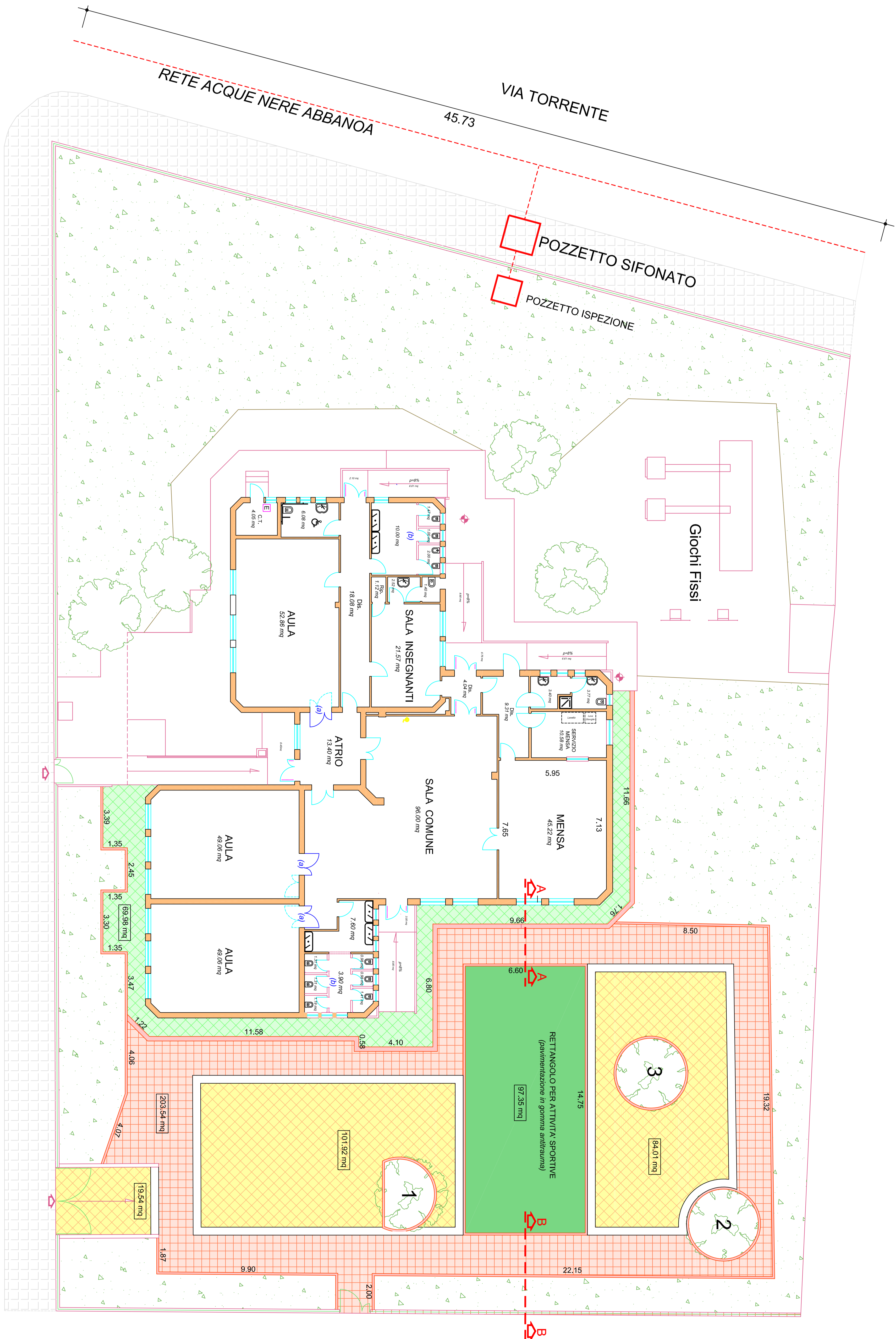

IL SINDACO
Gianfranco CAPPALÀ

IL DIRETTORE AREA E
Ing. Adalberto RIBBI

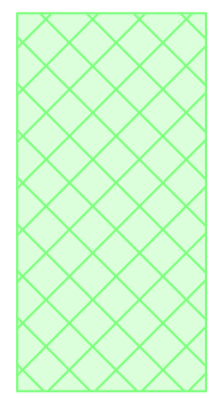
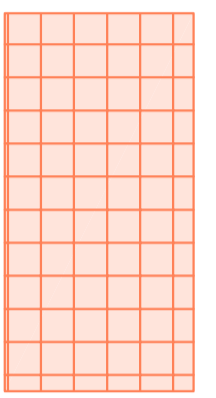
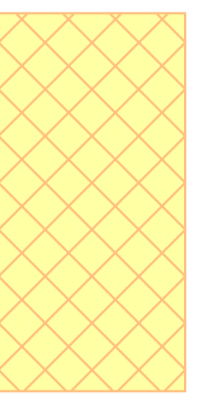
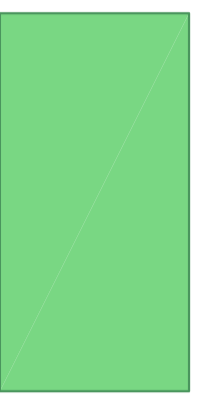

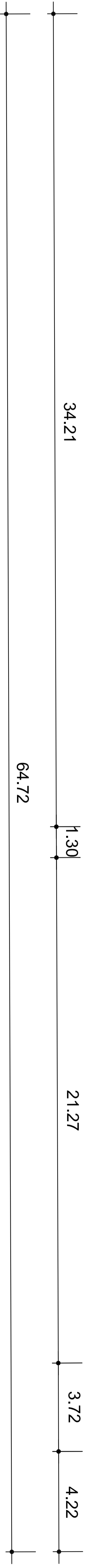
-  PAVIMENTAZIONE MARCIAPIEDE - 69,98 mq
-  PAVIMENTAZIONE CORTILE - 203,54 mq
-  PAVIMENTAZIONE CORTILE - 205,47 mq
-  PAVIMENTAZIONE IN GOMMA ANTITRAUMA - 97,35 mq
-  PAVIMENTAZIONE ROMPITRATTA - 41,05 mq

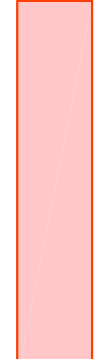
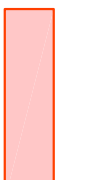

-  CORDONATA COLORATA - 174,72 ml
-  MATTONE PIENO 6x12x25 cm - 42,70 ml
-  (a) INVERSIONE PORTE AULE DIDATTICHE
-  (b) REVISIONE ANTE TIPO SALOON